



ESTES INDUSTRIES
1295 H Street
Penrose, CO 81240

SITH INFILTRATOR™

Flying Model Rocket Kit Instructions

STAR
WARS™
EPISODE I

(11-98) 84405 EST 1829

MATERIALS REQUIRED: PENCIL, TUBE-TYPE PLASTIC CEMENT, WHITE OR YELLOW GLUE, HOBBY KNIFE, SANDPAPER, RULER, SCISSORS. BE SURE TO READ ALL INSTRUCTIONS, TEST FIT ALL PARTS, AND SAND AS NECESSARY BEFORE GLUING.

ALL GLUED AREAS ARE SHADED IN GRAY

PARTS LAYOUT

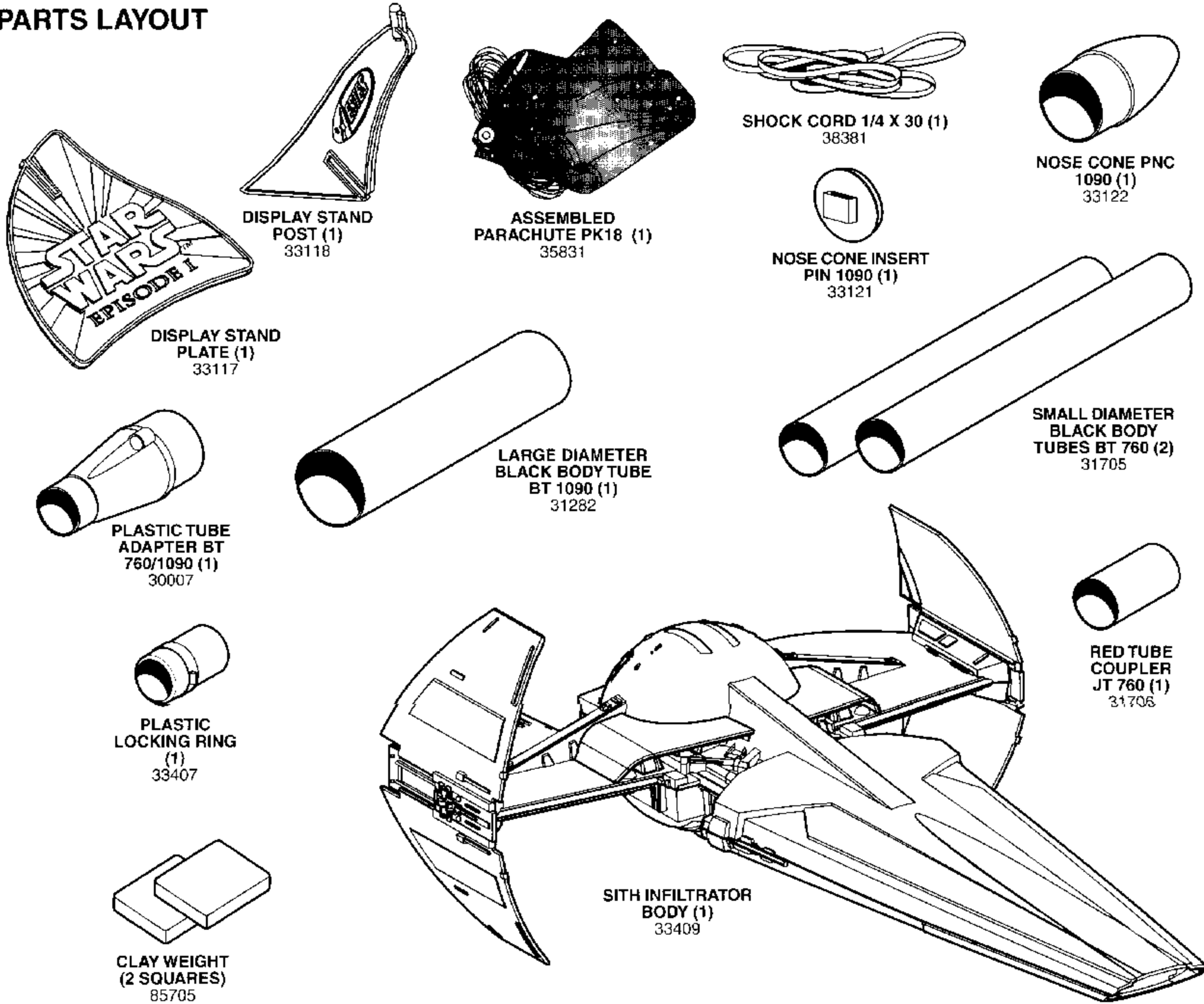

1. THE DISPLAY STAND

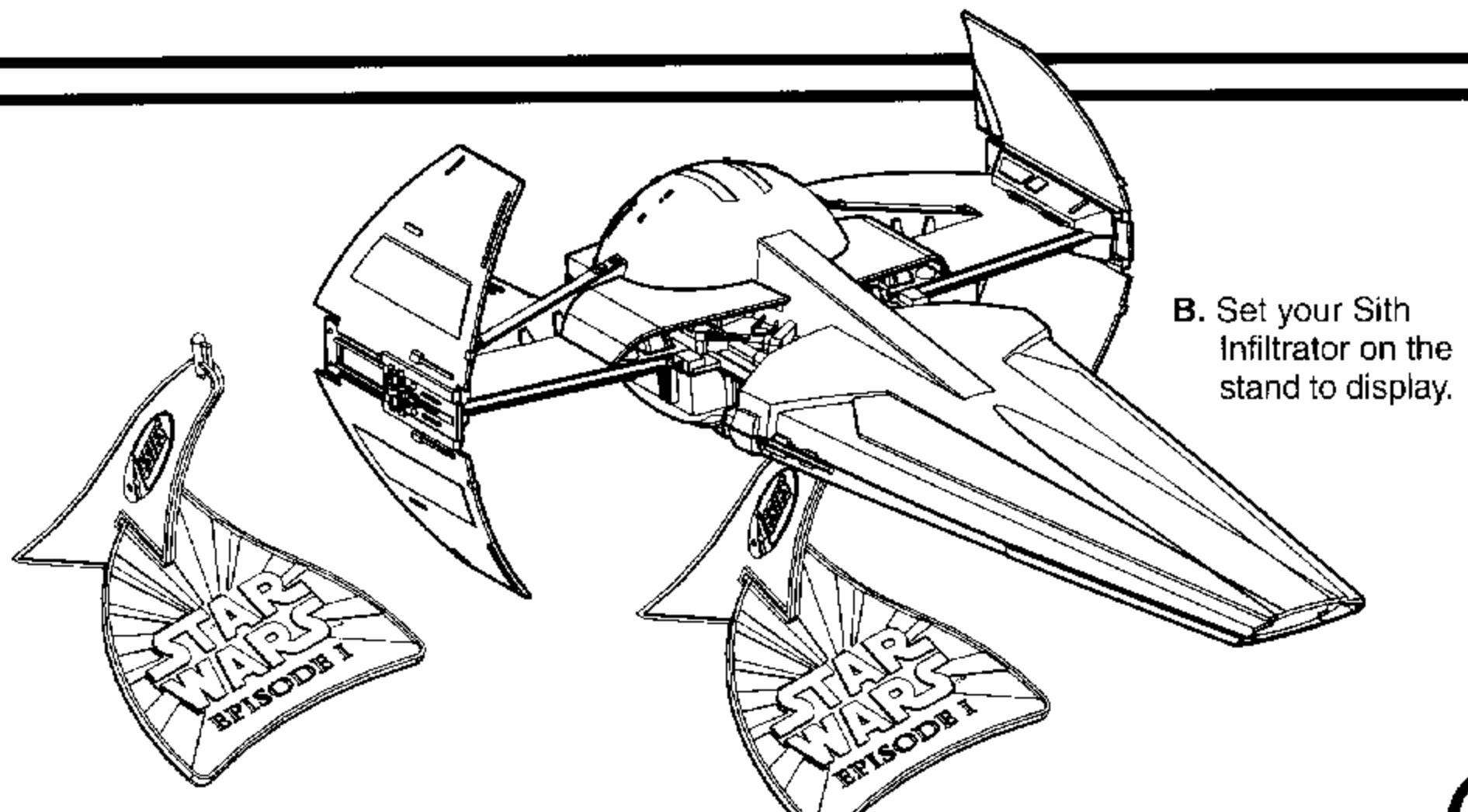
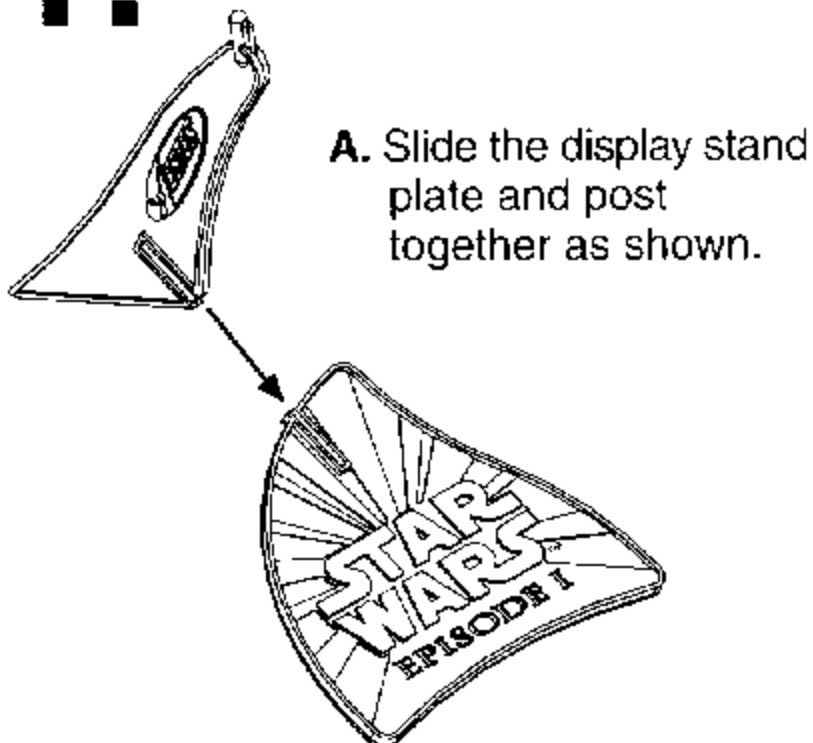

1. BUILDING THE FLIGHT PROBE

A. Roll the clay weight into "snakes", drop into the nose cone, and press firmly into place.

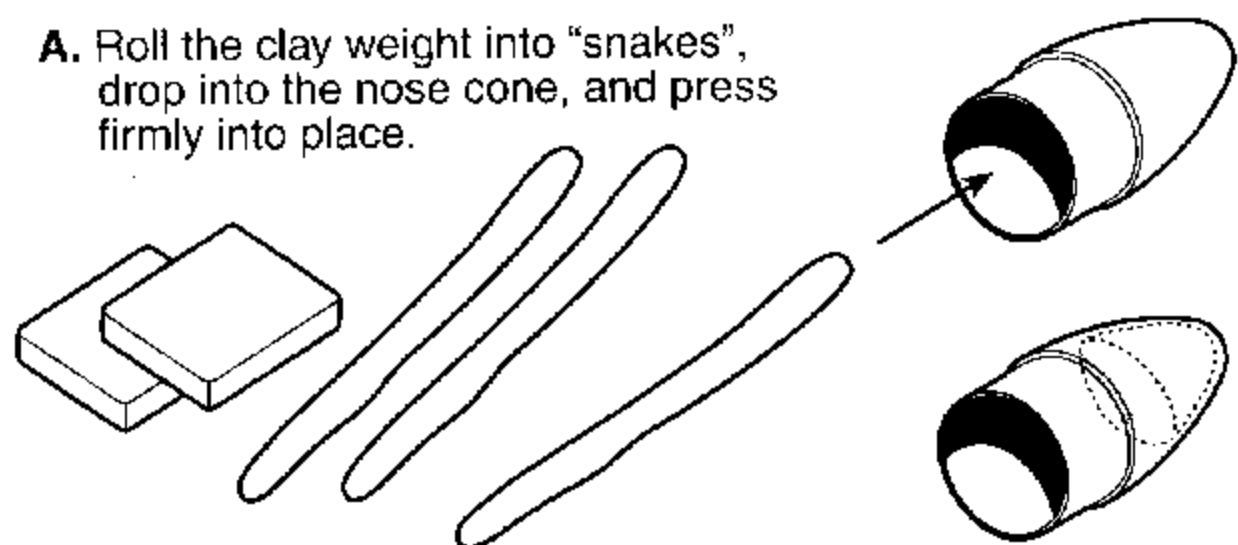

B. Apply a ring of plastic cement just inside the nose cone, and slide the plastic nose cone insert into place. Let dry.

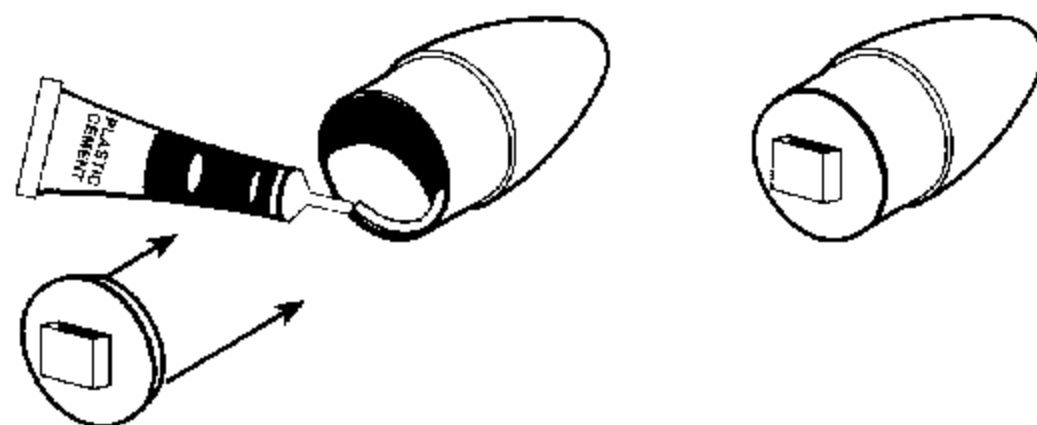

2. A. Tie a double knot in one end of the shock cord, and cut the other end at an angle as shown.

DOUBLE KNOT

CUT AT AN ANGLE

B. Feed the shock cord through the cavity in the plastic tube adapter until the knot fits into the cavity.

C. Feed the shock cord through the front end of the plastic tube adapter, and then through the large diameter black body tube.

D. Apply a ring of plastic cement just inside the rear end of the tube. Be careful not to get plastic cement on the shock cord!

E. Slide the body tube down onto the shoulder of the adapter until it rests evenly all the way around. Let dry.

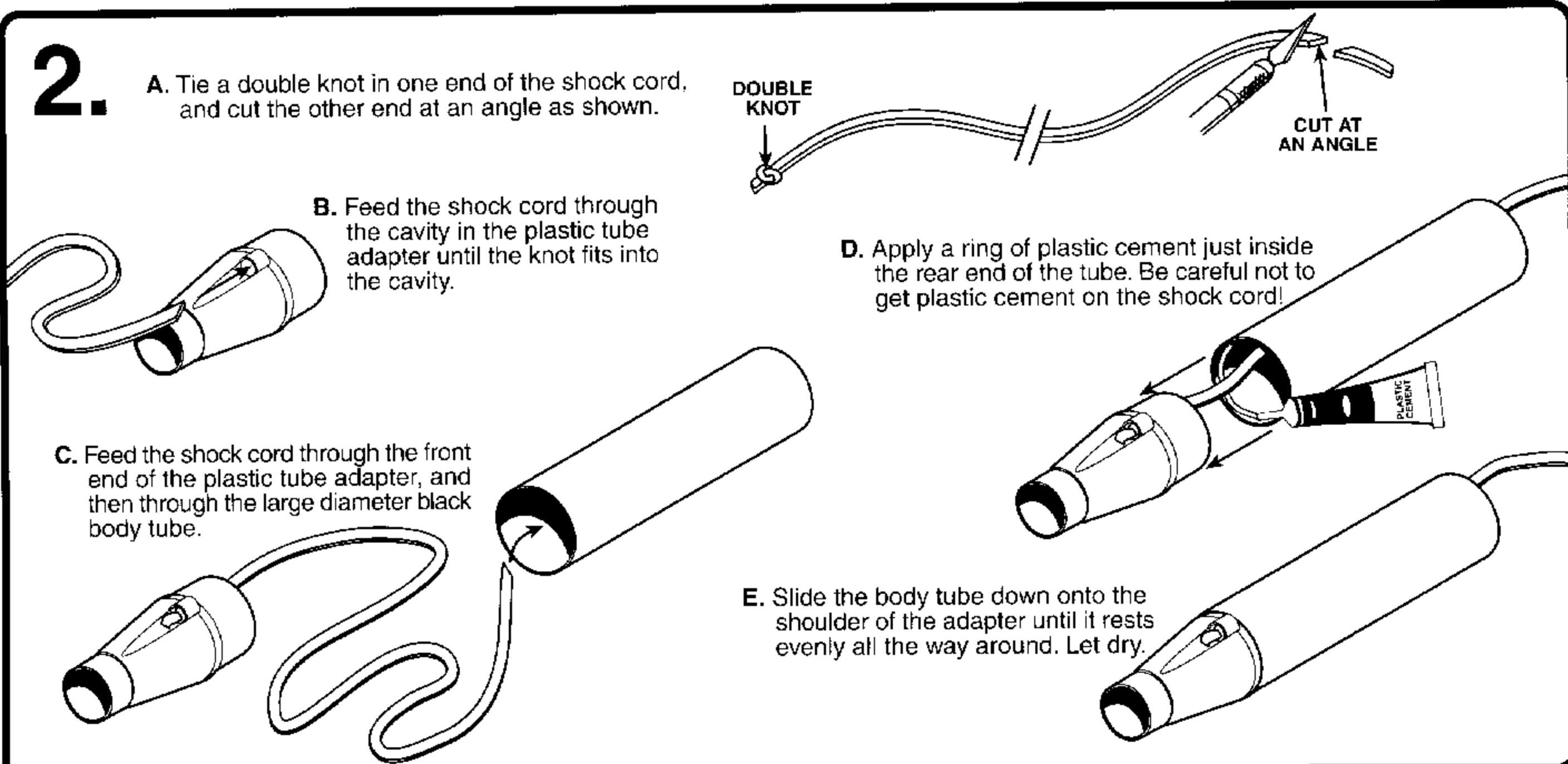

3. A. Mark the halfway point on the red tube coupler.

3/4" (19 mm)

B. Test fit the red tube coupler into one end of one of the small diameter tubes, remove, apply a ring of white or yellow glue just inside the tube, and reinsert coupler up to mark. LET DRY.

C. Apply a ring of white or yellow glue just inside one end of the other small diameter tube, and slide tube down over coupler until tubes are perfectly joined. Roll the tube assembly on a flat surface to insure that it is straight and let dry.

D. Apply a ring of plastic cement just inside one end of the tube assembly, and slide the assembly onto the plastic tube adapter. Let dry.

E. Apply a ring of plastic cement just inside the free end of the tube assembly and slide the longer end of the plastic locking ring into place. This is now the rear of the tube assembly. Let dry.

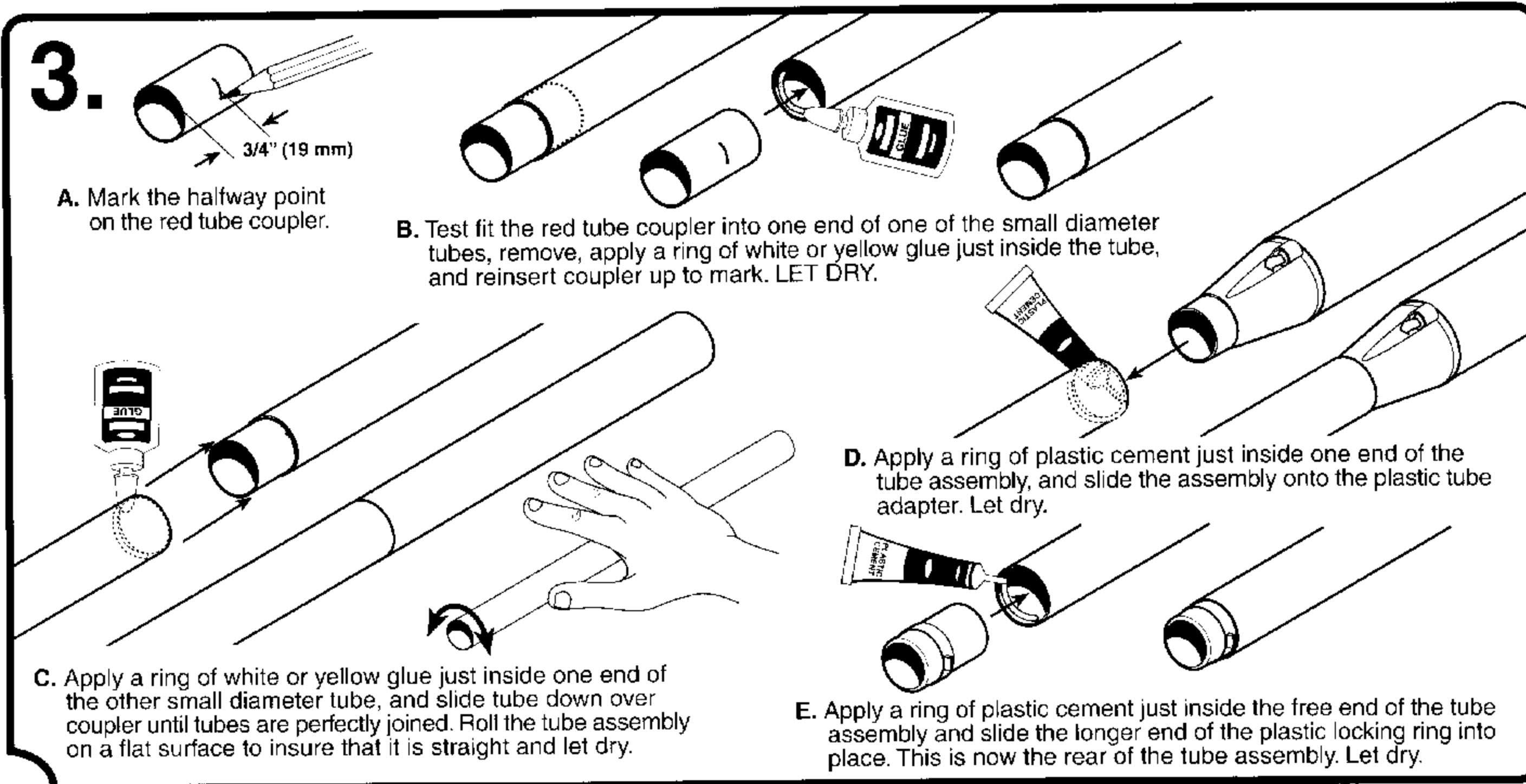

4.

A. Form a loop with the parachute shroud lines.

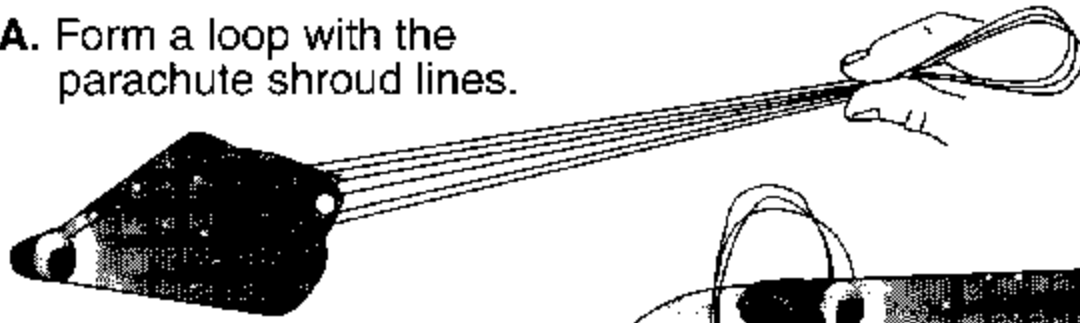

B. Feed loop through eyelet.

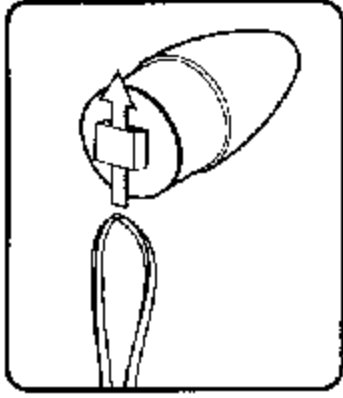

C. Pass parachute through loop.

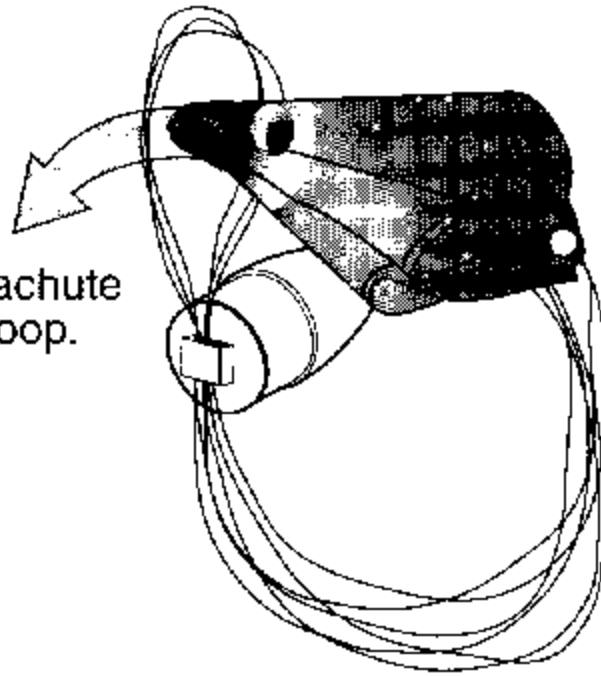

D. Pull tight.

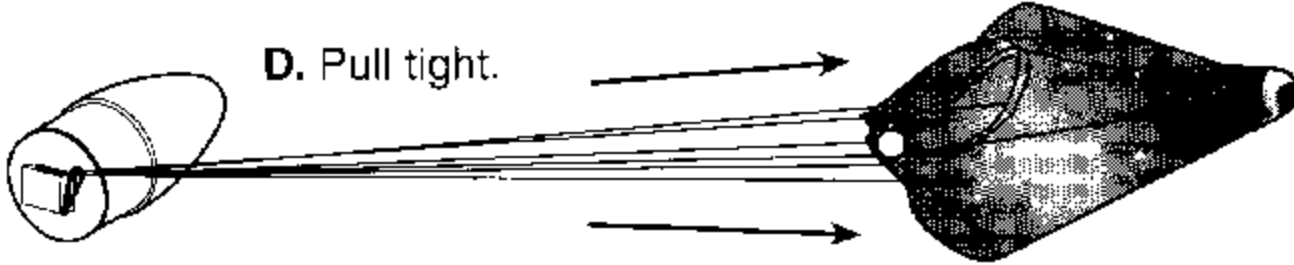

E. Tie the free end of the shock cord to the nose cone eyelet with a double knot.

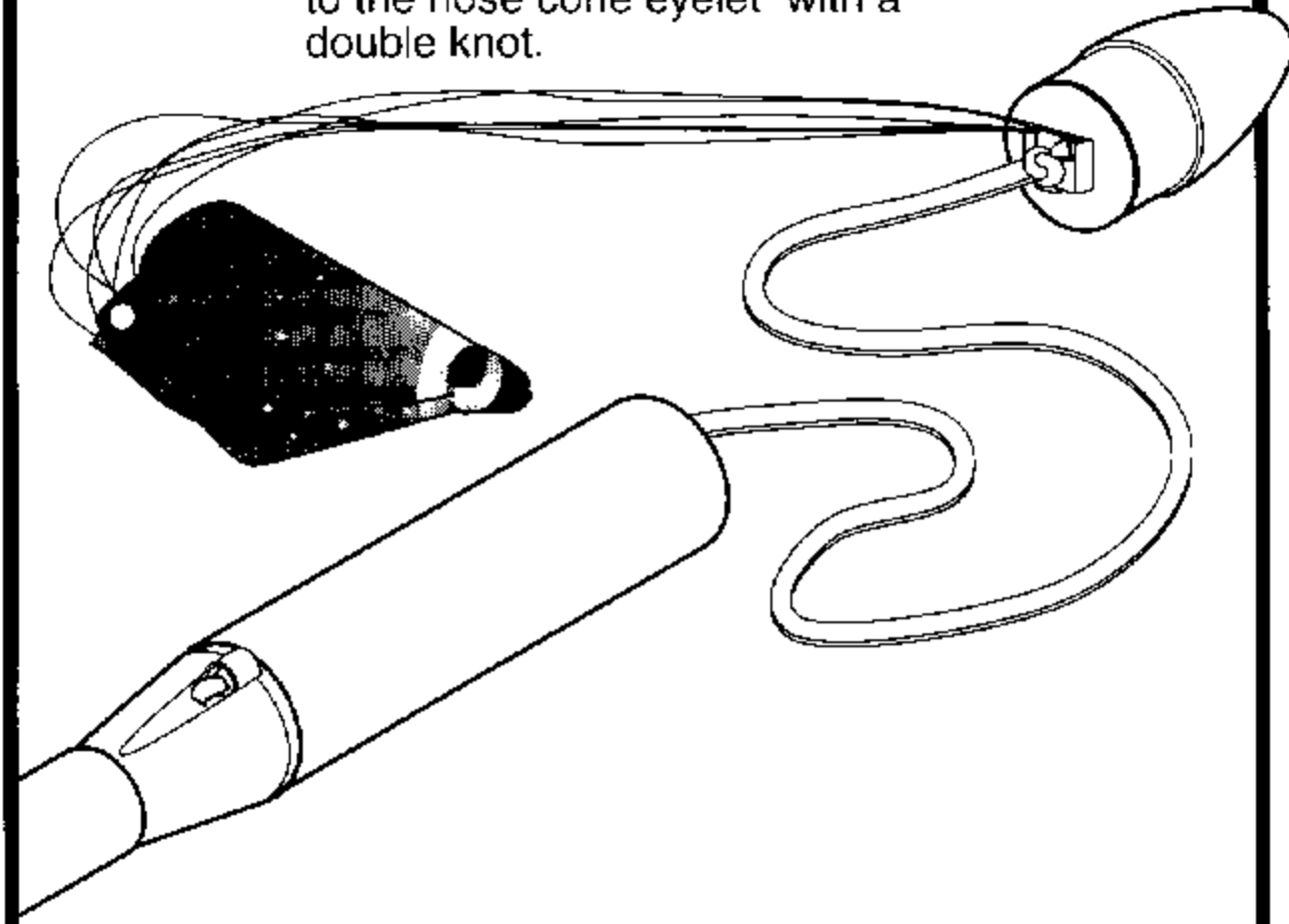

5. PARACHUTE PREPARATION

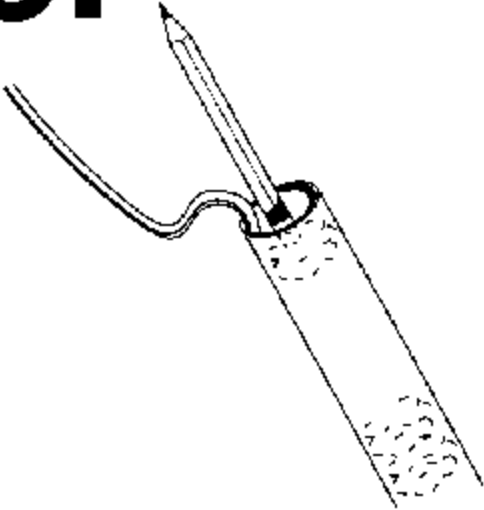

A. Crumple and insert four squares of recovery wadding into the front of the probe.

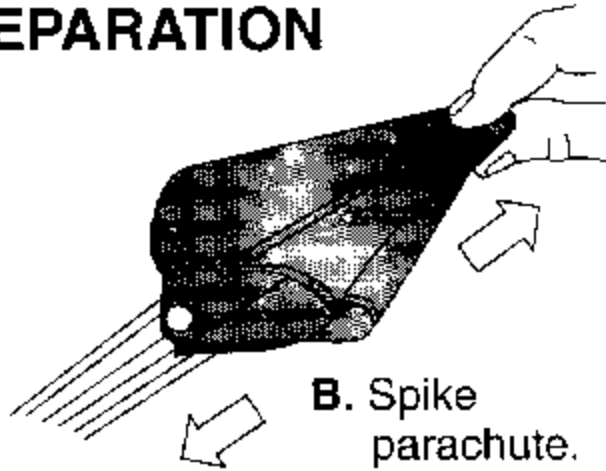

B. Spike parachute.

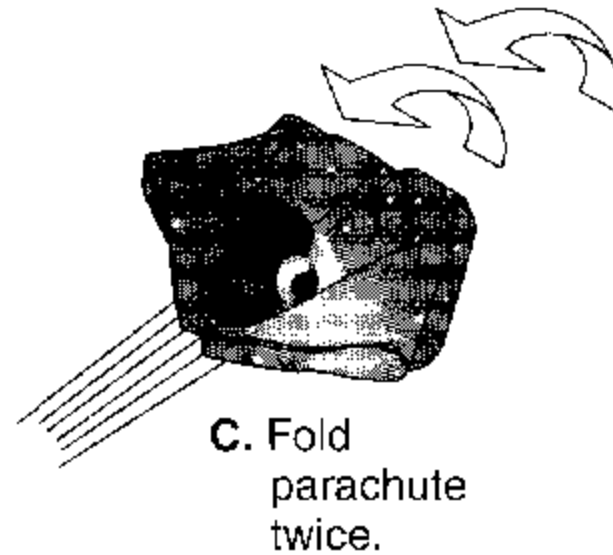

C. Fold parachute twice.

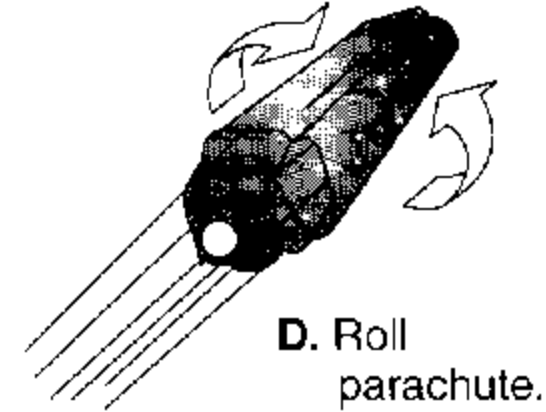

D. Roll parachute.

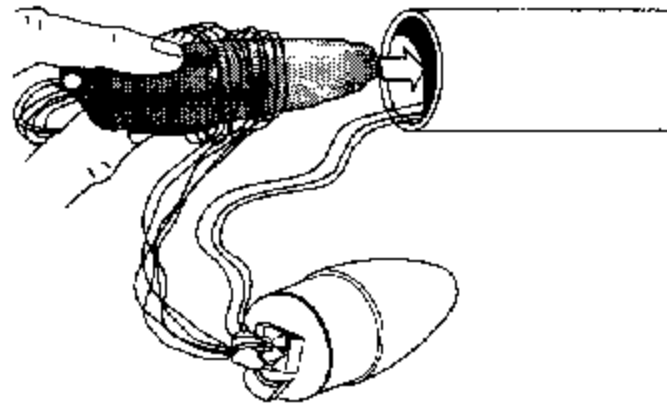

E. Wrap lines loosely around 'chute. Insert shock cord and parachute into flight probe. Parachute should slide easily into body tube. If fit is too tight, unfold and repack again.

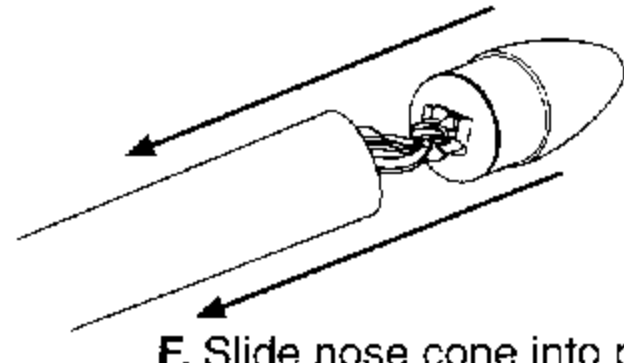

F. Slide nose cone into place.

6. PREPARING YOUR SITH INFILTRATOR FOR FLIGHT MODE

A. Remove the display nose.

THIS PIECE IS FOR DISPLAY ONLY! DO NOT ATTEMPT TO FLY YOUR SITH WITH IT IN PLACE.

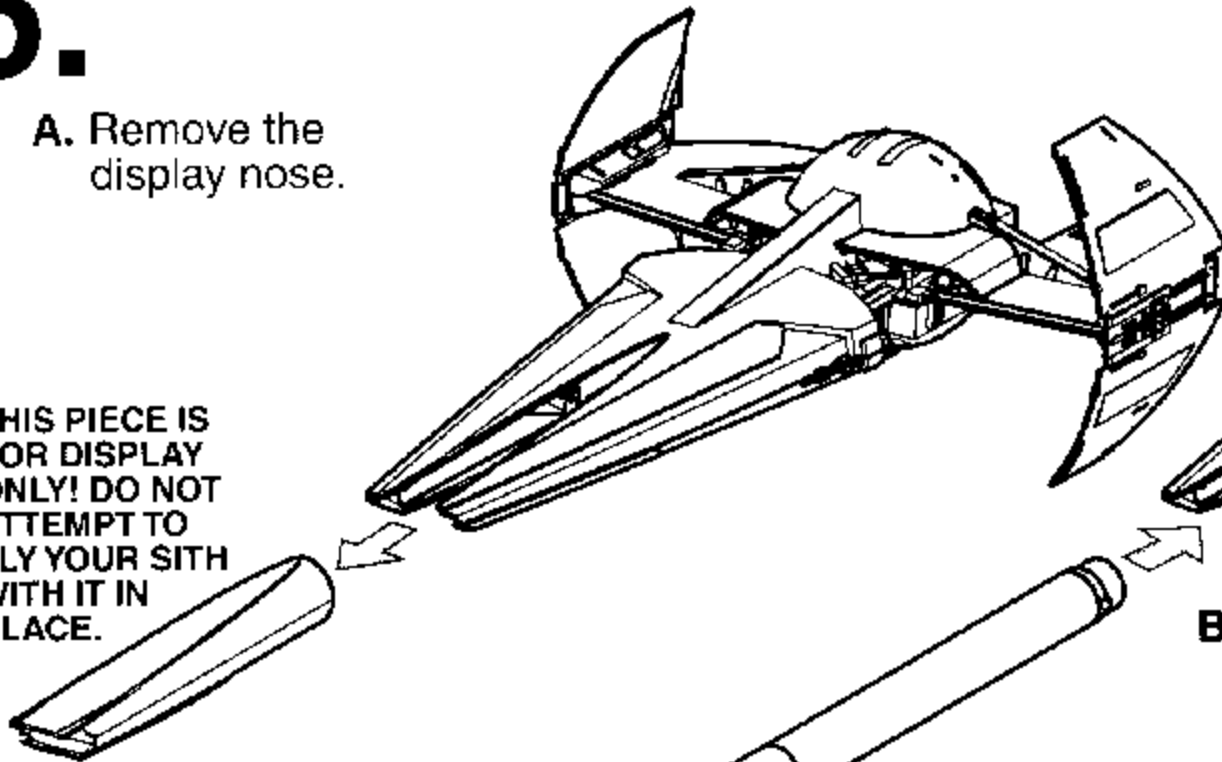

B. Slide the flight probe into your Sith Infiltrator, and twist until locked in place.

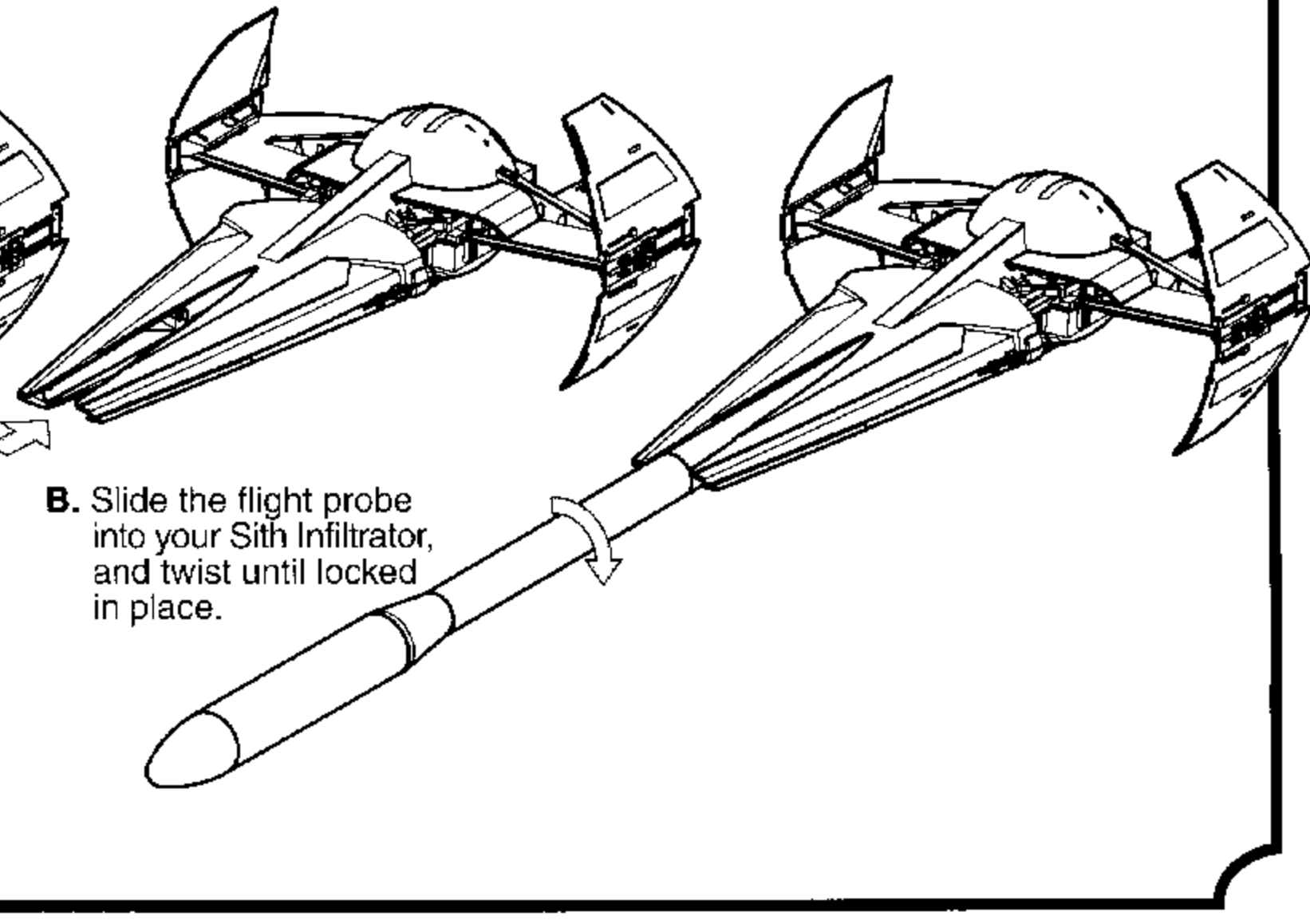

7. ENGINE PREPARATION

A. Turn the Sith Infiltrator upside down, and slide engine into engine mount until it is captured by the engine hook.

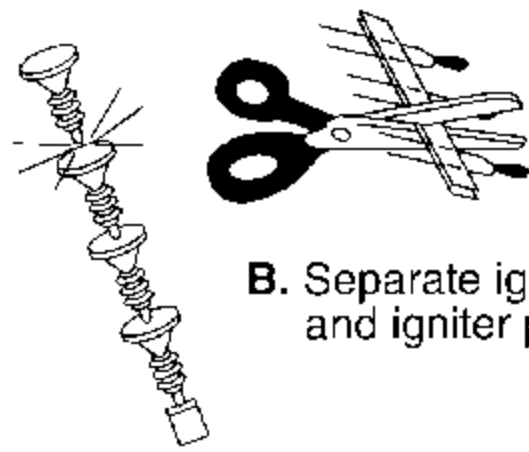
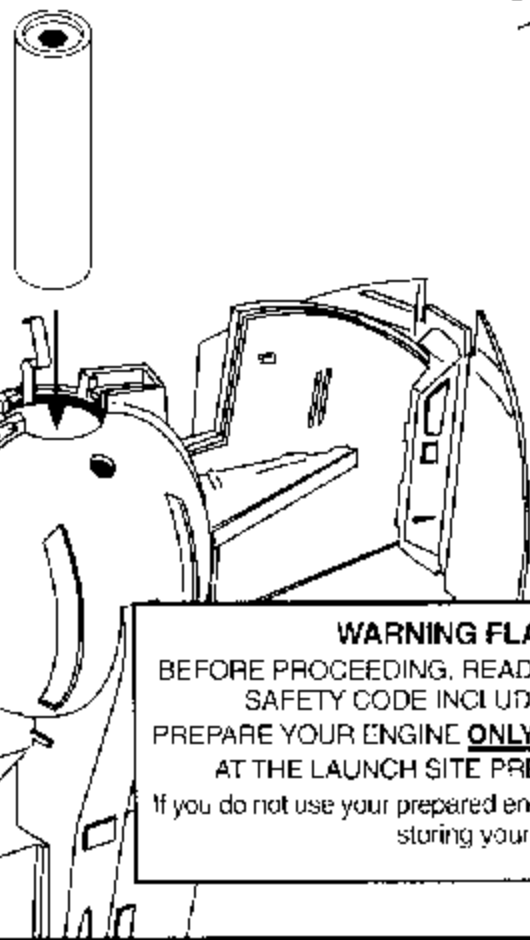

B. Separate igniter and igniter plug.

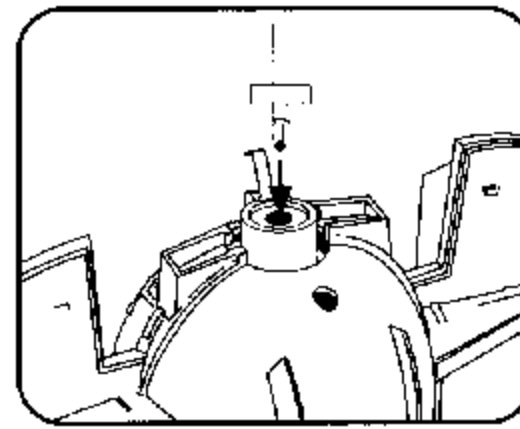

C. Drop in igniter. Igniter must touch propellant.

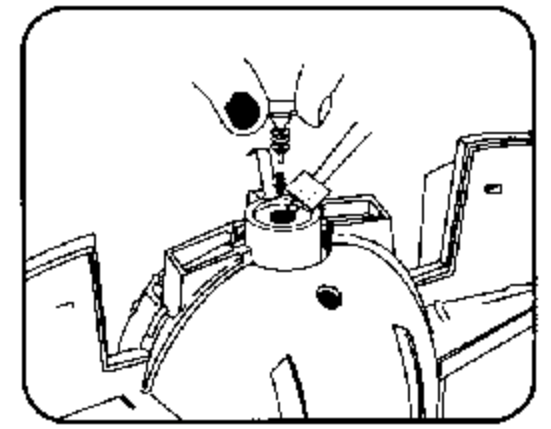

D. Insert igniter plug.

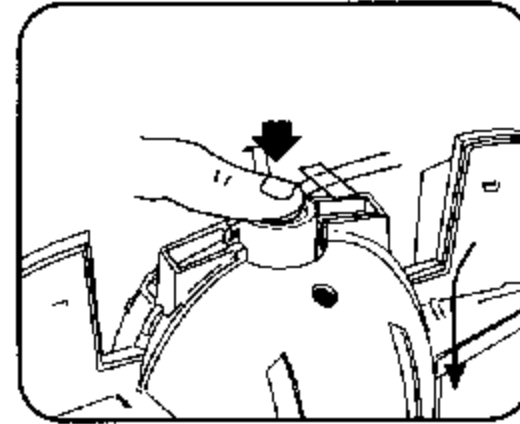

E. Firmly push all the way in.

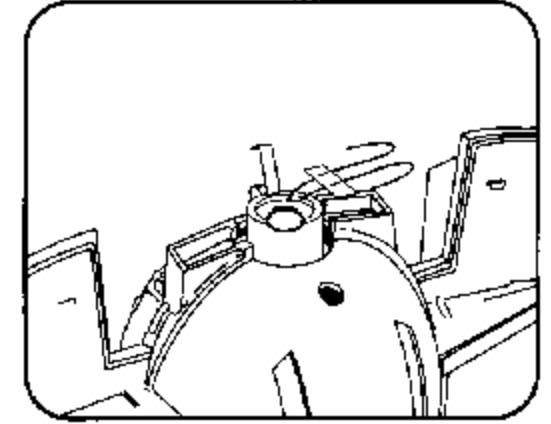

F. Bend igniter wires back as shown.

WARNING FLAMMABLE:
BEFORE PROCEEDING, READ INSTRUCTIONS AND NAR SAFETY CODE INCLUDED WITH ENGINES. PREPARE YOUR ENGINE **ONLY** WHEN YOU ARE **OUTSIDE** AT THE LAUNCH SITE PREPARING TO LAUNCH!
If you do not use your prepared engine, remove the igniter before storing your engine.

10... COUNTDOWN AND LAUNCH

Safety key must not be in launch controller. The safety cap with safety key attached should already be on the launch rod.

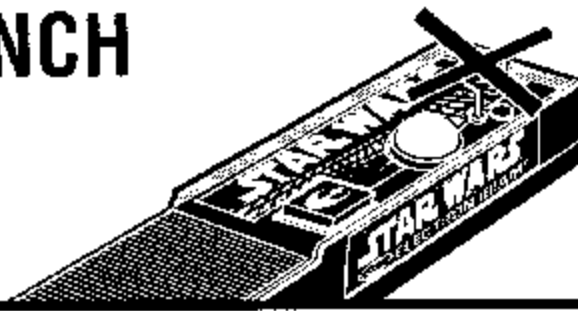

9...

Remove safety cap from launch rod, slide launch rod through launch lugs in body. Make sure rocket slides freely and micro-clips are clean for good electrical contact.

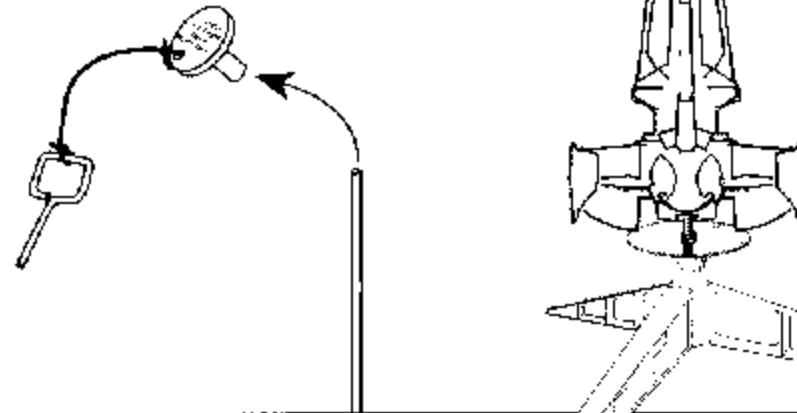

8...

Attach micro-clips to the igniter wires. Arrange the micro-clips so they do not touch each other or the metal blast deflector. Attach micro-clips as close to protective tape on igniter as possible.

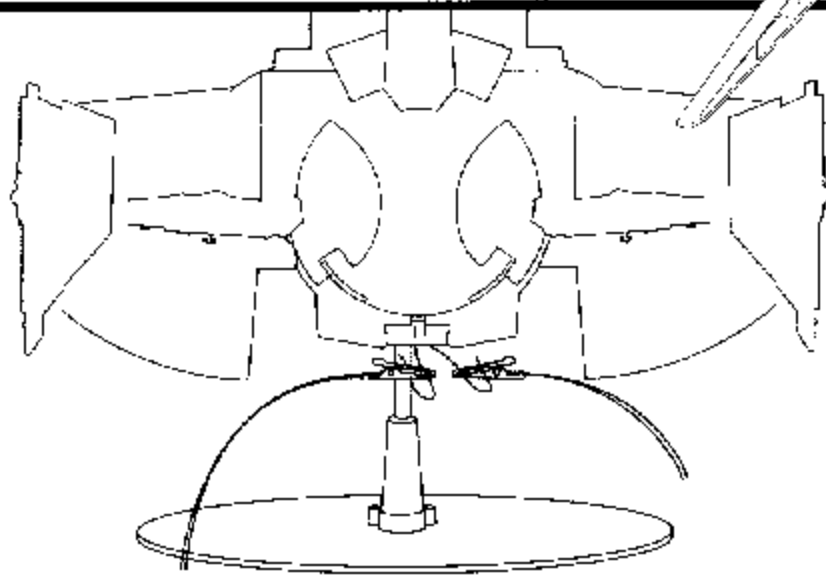

7...

Move everyone back from your rocket as far as launch wire will permit at least 15 feet (5 meters).

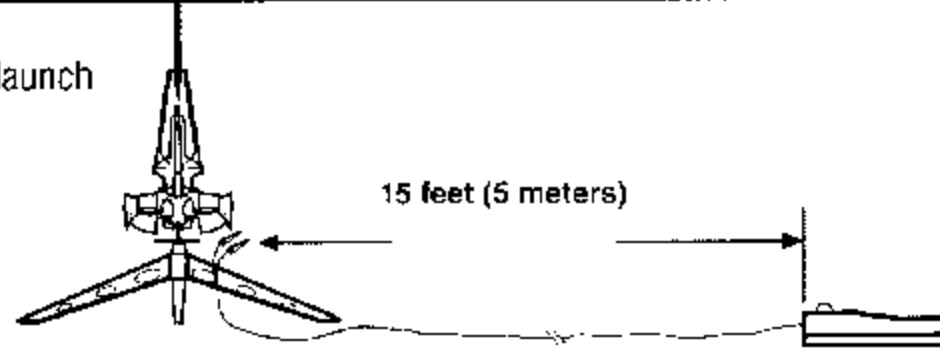

6...

Insert safety key to arm the launch controller.



5...

Start audible countdown.

4...

3...

2... 1... LAUNCH!

Push and hold button until engine ignites.

For safety, immediately remove safety key from launch controller. Replace safety cap on launch rod.

MISFIRES

When an ignition failure occurs, **remove the safety key** from the launch control system and **wait one minute before approaching the rocket.** Remove the expended igniter from the engine and install a new one. Be certain the coated tip is in direct contact with the engine propellant. Broken or chipped coating will not affect the performance of the igniter. Reinstall the igniter plug as illustrated previously. Repeat the countdown and launch procedure.

LAUNCH SUPPLIES

- To launch your rocket, you will need the following:
- Launch Pad (Estes Porta-Pad® II)
 - Launch Controller (Electron Beam®, R2-D2™ or Laser™ Launcher.)
 - Recommended Estes Engines: C6-3 or C5-3. Use a C6-3 engine for your first flight to become familiar with your rocket's flight pattern.
 - Recovery Wadding (EST 302274)
 - Igniters and Igniter Plugs (included with Estes engines)
- Use only Estes products to launch this rocket.

PROJECTED ALTITUDE

| Engine | Feet | Meters |
|--------|------|--------|
| C6-3 | 187 | 57 |
| C5-3 | 200 | 61 |

TIPS FOR FLYING YOUR ROCKET

- Choose a large field away from power lines, buildings, tall trees, and low flying aircraft. Try to find a field at least 250 feet (76 meters) square. The larger the launch area, the better your chance of recovering your rocket.
- Launch area must be free of dry weeds and brown grass.
- Launch only during calm weather with little or no wind and good visibility.
- Don't leave parachute packed more than a minute or so before launch during cold weather (colder than 40° Fahrenheit [4° Celsius]). Parachute may be dusted with talcum or baby powder to avoid sticking.
- Always follow the National Association of Rocketry (NAR) MODEL ROCKETRY SAFETY CODE while participating in any model rocketry activities. The safety code is enclosed with this kit.

© Lucasfilm Ltd. & TM. All rights reserved. Used under authorization.

© 1998 Centuri Corp. All rights reserved.